

# Coaxial Spot Light

## SLDH-A20-□

Spot LED is a powerful LED and used for lens magnification higher than 3X. The outer dimension is designed for a maximum of 22mm to facilitate the needs of system integrators. This illuminator is useful not only for coaxial illumination but for spot illumination as well.

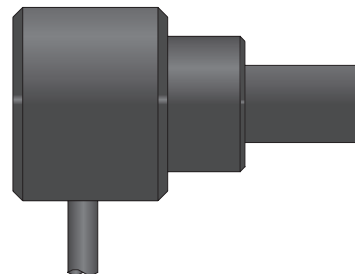

### Specifications

Model	SLDH-A20-W	SLDH-A20-R	SLDH-A20-G	SLDH-A20-B	SLDH-A20-Y
Input Current	350mA				
Color Temperature/ Peak Wavelength	6500K typ.	635nm typ.	525nm typ.	465nm typ.	490nm typ.
Cable Length	1000m				
Input Connector	SM connector(SMR-03V-B)				
Polarity	1:+ 2:- 3:NC				
Ambient Temperature	0~+40°C				
Ambient Humidity	35~85% (non condensing)				
Weight	35g				
Adaptable Compliance	RoHS,IEC 62471				

### Diagram:

